

Figura	Diámetro	Espesor	Peso	
			Lbs.	Kg.
SC 1	8/32"	1/4" (6.3)	7.0	(3.17)
SC 2	10/32"	1/4" (6.3)	7.0	(3.17)
SC 3	#10-24	1/4" (6.3)	7.0	(3.17)
SC 4	1/4"-20	1/4" (6.3)	7.0	(3.17)
SC 5	5/16"-18	1/4" (6.3)	7.0	(3.17)
SC 6	5/16"-18	3/8" (9.5)	9.0	(4.08)
SC 7	3/8"-16	3/8" (9.5)	9.0	(4.08)
SC 8	7/16"-14	3/8" (9.5)	9.0	(4.08)

Figura	Diámetro	Espesor	Peso	
			Lbs.	Kg.
SC 9	1/2"-13	3/8" (9.5)	8.3	(3.8)
SC 10	1/2"-13	1/2" (12.7)	11.0	(4.98)
SC 11	9/16"-12	1/2" (12.7)	11.0	(4.98)
SC 12	5/8"-11	3/8" (9.5)	14.0	(6.34)
SC 13	5/8"-11	7/16" (11.2)	15.5	(7.07)
SC 14	3/4"-10	3/8" (9.5)	13.6	(6.16)
SC 15	3/4"-10	7/16" (11.2)	14.0	(6.34)
SC 16	7/8"-9	7/16" (11.2)	13.5	(6.12)



Figura	Diámetro	Espesor	Peso	
			Lbs.	Kg.
SC 17	#8/32"	1/4" (6.3)	7.5	(3.40)
SC 18	#10/32"	1/4" (6.3)	7.5	(3.40)
SC 19	#10-24	1/4" (6.3)	7.5	(3.40)
SC 20	1/4"-20	1/4" (6.3)	7.5	(3.40)
SC 21	5/16"-18	1/4" (6.3)	7.5	(3.40)
SC 22	5/16"-18	3/8" (9.5)	10.0	(4.53)
SC 23	3/8"-16	3/8" (9.5)	10.0	(4.53)
SC 24	1/2"-13	3/8" (9.5)	8.8	(3.99)
SC 25	1/2"-13	1/2" (12.7)	11.5	(5.21)

Figura	Diámetro	Espesor	Peso	
			Lbs.	Kg.
SC 26	#8-32	1/4" (6.3)	7.5	(3.40)
SC 27	#10-32	1/4" (6.3)	7.5	(3.40)
SC 28	#10-24	1/4" (6.3)	7.5	(3.40)
SC 29	1/4"-20	1/4" (6.3)	7.5	(3.40)
SC 30	5/16"-18	1/4" (6.3)	7.5	(3.40)
SC 31	5/16"-18	3/8" (9.5)	10.0	(4.53)
SC 32	3/8"-16	3/8" (9.5)	10.0	(4.53)
SC 33	7/16"-14	3/8" (9.5)	10.0	(4.53)
SC 34	1/2"-13	1/2" (12.7)	11.5	(5.21)
SC 35	9/16"-12	1/2" (12.7)	11.5	(5.21)
SC 36	5/8"-11	7/16" (11.2)	16.0	(7.25)
SC 37	3/4"-10	7/16" (11.2)	14.5	(6.57)
SC 38	7/8"-9	7/16" (11.2)	14.0	(6.34)

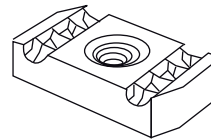
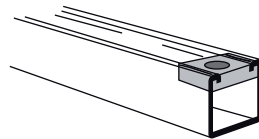